

# STAINLESS STEEL CONDUIT BODY COVERS

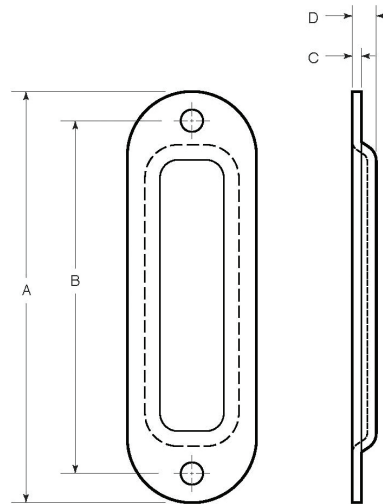

## APPLICATION

- Stainless steel conduit body covers can be sold separately from the conduit bodies
- Fits the following conduit body configurations: C, LB, LL, LR, T, TB, X
- Form 8
- Supplied complete with gasket and Type 316 SS screws
- Manufactured in stainless steel to help prevent corrosion
- Can be installed using ordinary hand tools and require little maintenance or repair
- Provided in a bright, polished finish that does not require touch up or painting

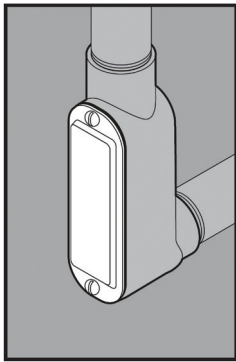

## PRODUCT DETAILS

### Material:

- Cover, Screws: 316 SS
- Gasket: Neoprene

### Standards:

ASTM A240, ASTM F593

### Country of Origin:

100% Made in USA

### \*UL File Number:

QCIT.E300676  
(Standard 514A)

### \*Canada UL File Number:

DWTT7.E300676  
(Standard 514A)

*\*When used with Gibson  
Stainless Conduit Body*

| Part Number | Conduit Size | Weight/ Each (lbs.) | Dimension (in.) |       |      |
|-------------|--------------|---------------------|-----------------|-------|------|
|             |              |                     | A               | B     | C    |
| 7050-2      | ½ in.        | <1                  | 4.10            | 3.52  | 0.08 |
| 7075-2      | ¾ in.        | <1                  | 4.81            | 4.31  | 0.08 |
| 7100-2      | 1 in.        | <1                  | 5.63            | 5.00  | 0.08 |
| 7125-2      | 1-¼ in.      | <1                  | 6.75            | 6.00  | 0.08 |
| 7150-2      | 1-½ in.      | <1                  | 7.34            | 6.58  | 0.08 |
| 7200-2      | 2 in.        | <1                  | 9.44            | 8.50  | 0.08 |
| 7300-2      | 3 in.        | 1.32                | 11.97           | 11.25 | 0.08 |
| 7400-2      | 4 in.        | 1.99                | 15.00           | 13.75 | 0.08 |

